

# Innovator<sup>®</sup> CableFlex<sup>™</sup>



 **ADA**  
Optional  
ADA handle.

**928-CA**  
**938-CA**  
**948-CA**

Optional  
Theft-Resistant  
Device  
**NO CHARGE**



**Overflow  
Test Cap  
Included**



Standard flexible  
stopper prevents  
stubbing of toe or  
breakage of stopper  
stem.



Repairs can easily be made from inside tub by simply removing three screws and replacing old cable.

## **928-CA Innovator<sup>®</sup> CableFlex<sup>™</sup>**

**For most tubs up to 16" deep; 21" cable**

## **938-CA Innovator<sup>®</sup> CableFlex<sup>™</sup>**

**For most tubs up to 24" deep; 34" cable**

## **948-CA Innovator<sup>®</sup> CableFlex<sup>™</sup>**

**For most tubs up to 36" deep; 48" cable**

### **SPECIFICATIONS**

#### **FEATURES:**

- Fully repairable from inside the tub.
- Fully-testable cable bath waste; test plug included
- Installs in minutes, like the Innovator<sup>®</sup>.
- ADA Handle and theft-resistant device options available.
- Self-centering; self-aligning.
- Positive mechanical stop stays open in deep water.
- Flexible stopper; no stubbed toes.

#### **APPROVALS:**

- Non-corrugated, flexible PVC tubing.
- Manufactured in compliance with ASME A112.18.2-2005/ CSA B125.2-05.
- IAPMO approved
- CSA approved

#### **PATENTS :**

- <https://www.watcomfg.com/patents>

#### **THREAD SIZE:**

- 1½" – 11½ NPSM (Coarse Thread)
- 1.865" Major Diameter (outside thread diameter)
- 11.5 threads per inch

#### **PIPING/FITTINGS:**

- Available in PVC only



For More Information Contact:  
**WATCO Manufacturing Company**  
1220 South Powell Road  
Independence, MO 64057-2724  
Ph. 816-796-3900 • FAX 816-796-0875

[www.watcomfg.com](http://www.watcomfg.com)

# Innovator® CableFlex™ Testable Cable

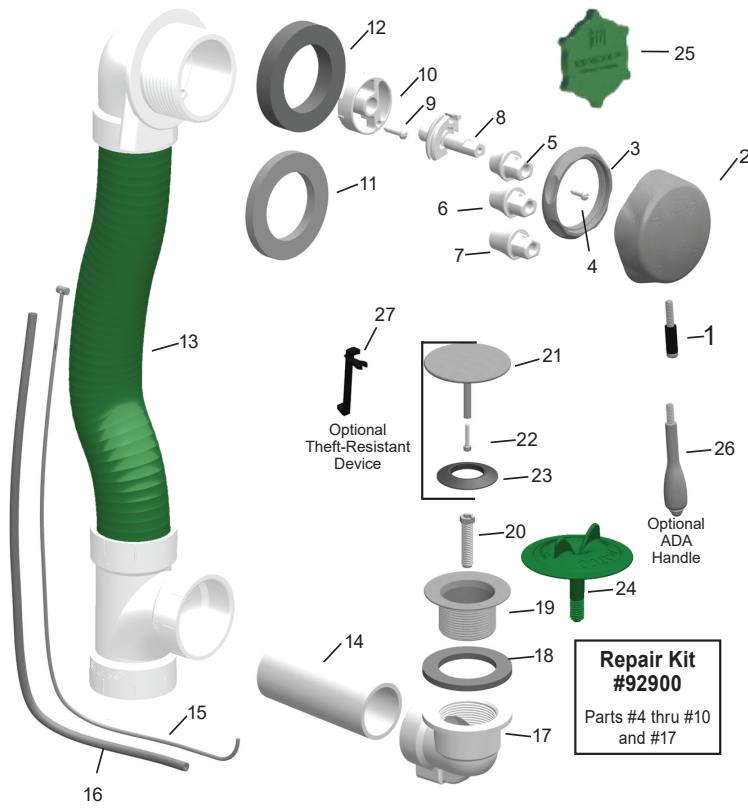

Item	Part #	Description
1	01032_*	Cable Faceplate Screw, 1/4-20x1-3/4 with Screw Guide
2	01019_*	Cable Faceplate
3	01047_*	Cable Overflow Elbow Retainer Nut
4	01037	Cable Adapter-to-Drive Shaft Screw, #8x5/8
5	01071	Cable Faceplate Adapter - Thin
6	01072	Cable Faceplate Adapter - Medium
7	01073	Cable Faceplate Adapter - Thick
8	20145	Cable Drive Shaft
9	01036	Cable Retainer-to-Overflow Elbow Screw #8x7/8
10	20146	Cable Retainer
11	10694	Overflow Elbow Gasket Half Height
12	10675	Overflow Elbow Gasket
13	Not Sold Separately	
14	SCHABS-4.625	928 Schedule 40 Pipe, ABS, 1.5" x 4.625"
	SCHPVC-4.625	928 Schedule 40 Pipe, PVC, 1.5" x 4.625"
	SCHABS-11.75	938 Schedule 40 Pipe, ABS, 1.5" x 11.75"
	SCHPVC-11.75	938 Schedule 40 Pipe, PVC, 1.5" x 11.75"
	SCHABS-11.75	948 Schedule 40 Pipe, ABS, 1.5" x 11.75"
15	20151	Cable Core
16	20161	Cable Conduit
17	11016	1-1/2" Schedule 40 Cable Drain Elbow, ABS
	14016	1-1/2" Schedule 40 Cable Drain Elbow, PVC
18	10696	Drain Elbow Gasket
19	01016_*	Strainer Body, Brass, 1.865" - 11.5x1.25"
20	20147	Cable Core Guide
21	92867-__*	Cable Stopper Assembly – includes the following:
22	20069	Stopper Adjusting Screw
23	11526	Stopper Seal, 1-1/16"
24	11577	Test Plug with O-Ring-Type Gasket
25	11114	Test Cap
<b>Optional Features:</b>		
26	92874-__*	ADA Handle and Handle Set Screw
27	01076	Cable Theft-Resistant Device

\* Please indicate desired finish.

Tub Closure:	Cable Stopper
AP - Aged Pewter	•
BB - Brushed Bronze	•
BN - Brushed Nickel	•
BS - Biscuit	•
BZ - Oil-Rubbed Bronze	•
CB - Chrome Brushed	•
CP - Chrome Plated	•
NP - Nickel Polished	•
PB - Polished Brass	•
WH - White	•
WI - Wrought Iron (Matte Black)	•