

For Residential and Commercial Applications

Job Name		Engineer / Architect	
Job Location		Wholesaler	
Submittal Date		Contractor	

1-**KA Copper Faucet Riser – Sweat Nosepiece

Use: For use in potable water distribution systems in accessible locations only.

Design Features:

- **One-piece construction**
- **Cut-to-Length** for clean, professional installation

Operating Specifications:

Temperature: 40° - 180° F
Pressure: 125 PSI maximum

Tubing Diameter: 0.38" OD



CONNECTOR MATERIAL SPECIFICATIONS			
Tube	Copper		
PART DIMENSIONS (Inches)			
Model	DIM. A	DIA. B	DIM. C
1-12KA	11.53	3/8	.62
1-15KA	14.53	3/8	.62
1-20KA	19.53	3/8	.62

Part Listing:

- 1-12KA C 3/8" ID sweat x 3/8" OD tube x 11-1/2" length, chrome plated
- 1-12KA R 3/8" ID sweat x 3/8" OD tube x 11-1/2" length, rough finish
- 1-12KA RBT 3/8" ID sweat x 3/8" OD tube x 11-1/2" length, rough finish, plain label, bulk
- 1-15KA R 3/8" ID sweat x 3/8" OD tube x 14-1/2" length, rough finish
- 1-20KA C 3/8" ID sweat x 3/8" OD tube x 19-1/2" length, chrome plated
- 1-20KA R 3/8" ID sweat x 3/8" OD tube x 19-1/2" length, rough finish

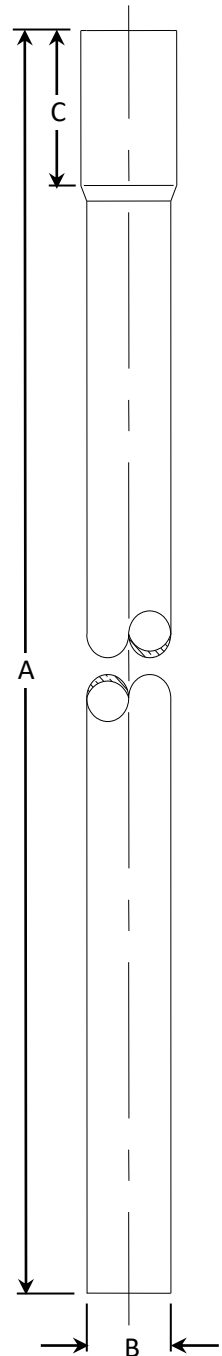

Listings & Certifications:

- IAPMO listed to ASME A112.18.1 / CSA B125.1 (including NSF/ANSI372 and NSF61)



This specification and all information contained herein is the confidential and exclusive property of Brasscraft Manufacturing Company and shall not be disclosed to others without the written consent of Brasscraft Mfg. Co. This specification must be returned to Brasscraft Mfg. Co. if requested.

BrassCraft®